

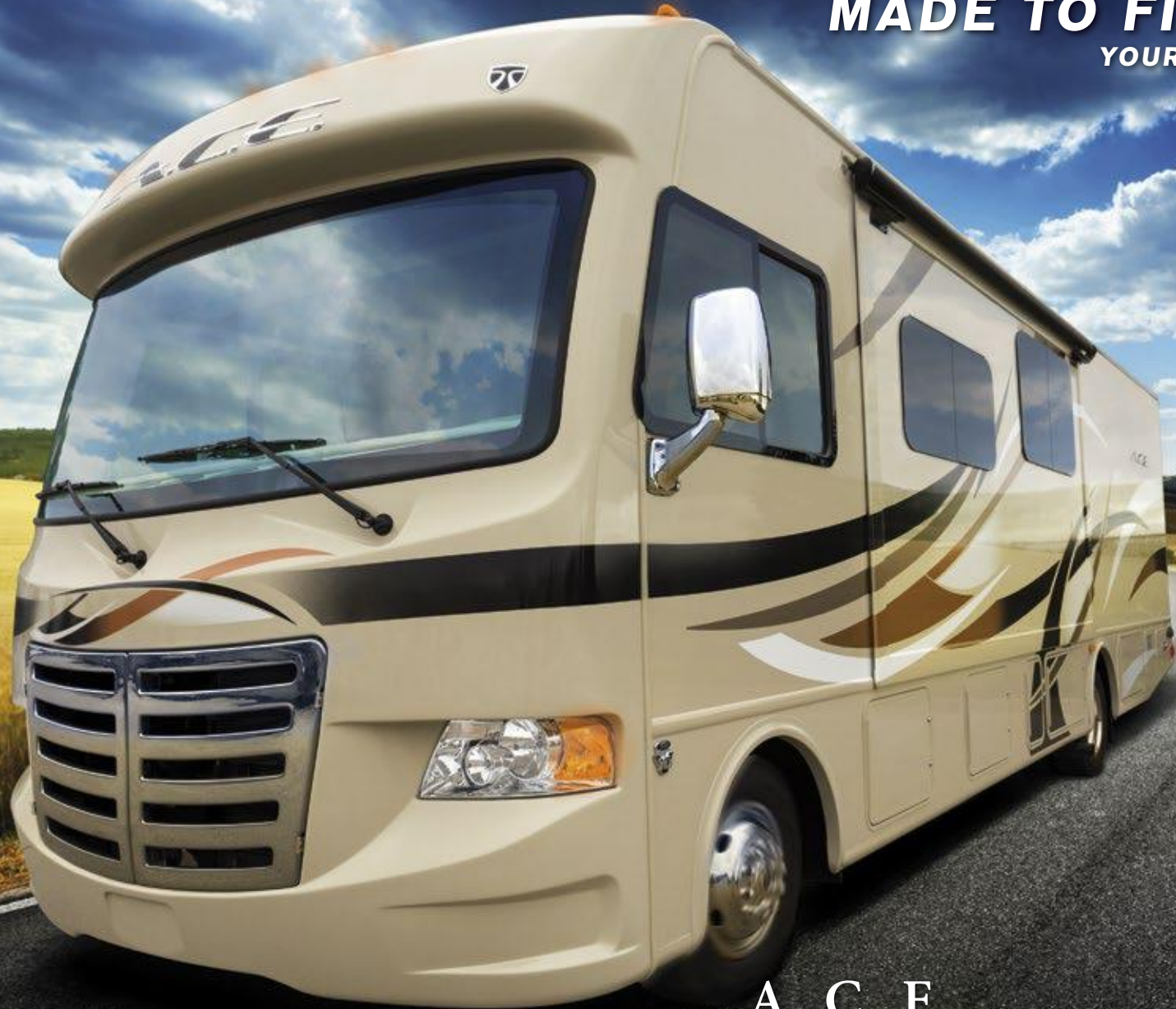

A.C.E.

**MADE TO FIT**  
YOUR FAMILY



A.C.E.

 BY THOR MOTOR COACH

## WHEN WE SAY *MADE TO FIT*, WE MEAN IT.

With so many unique models available, Thor Motor Coach motorhomes are priced to fit anyone's budget – from families buying their first motorhome, to full-timers looking for a roaming “dream home”. No matter how you choose to spend your time or your money, there's a TMC motorhome that fits your needs. Welcome to the A.C.E., the motorhome that is *Made to Fit* your family.



29.3 | CHERRY COBBLER | SYDNEY MAPLE



30.1 | SILVER LINING | OLYMPIC CHERRY



29.2 | MESA MINERAL | OLYMPIC CHERRY

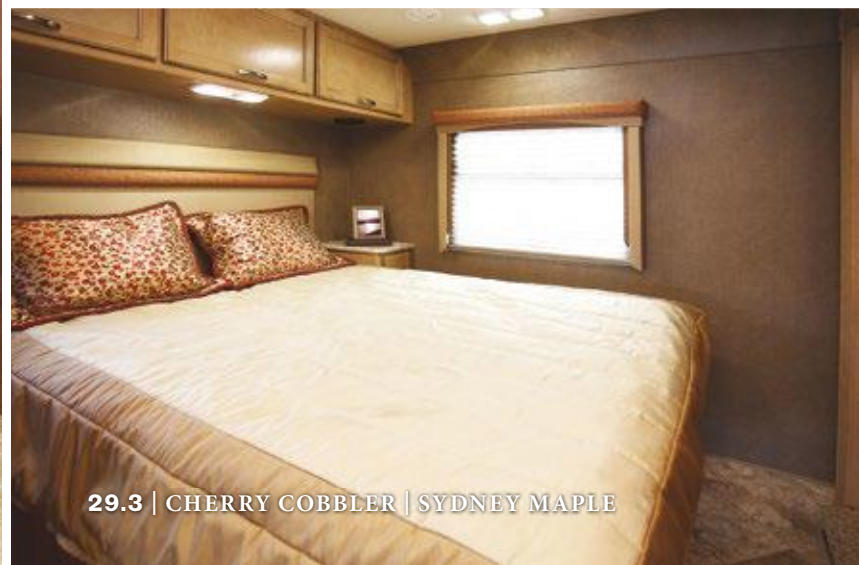

29.3 | CHERRY COBBLER | SYDNEY MAPLE





# BEAUTY INSIDE & OUT



29.2 | MESA MINERAL | OLYMPIC CHERRY

## BETTER HOMES AND GARDENS®

With the expectation that your RV looks more like a home, we are pleased to bring the top design trends and fashions from the nation's #1 lifestyle magazine into your home on wheels.

For 90 years, Better Homes and Gardens® has been America's trusted lifestyle brand, inspiring you to dream and create. Whether it's cooking, entertaining, gardening or home decorating, BHG is known as the down-to-earth guide for making everything "better." Our exclusive BHG RV Fabric Collection is the perfect fit of world class recognition and an accessible style point of view.

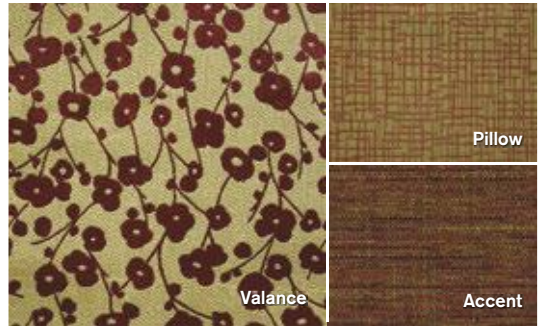

CHERRY COBBLER



FLOORING



MESA MINERAL



COUNTERTOPS



SILVER LINING



OLYMPIC CHERRY



SYDNEY MAPLE

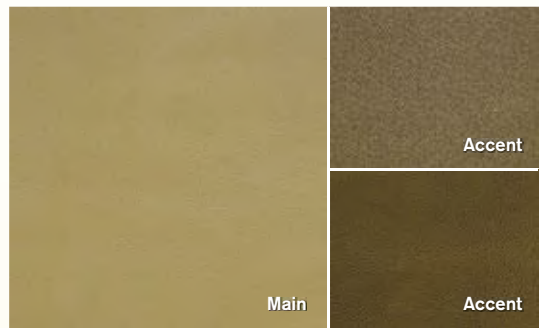

LEATHERETTE FURNITURE



AUTUMN SLATE FULL-BODY PAINT



TRAVERTINE FULL-BODY PAINT



HARMONY HD-MAX™ 



RHYTHM & BLUES HD-MAX™ 

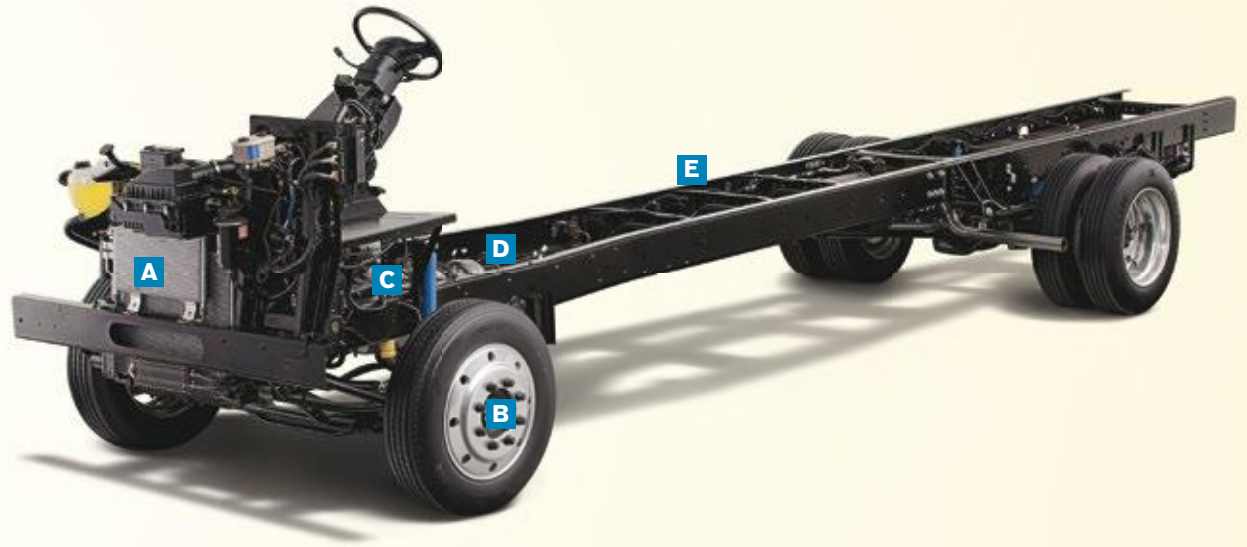

**A | TRITON® V10 ENGINE**

The 6.8L V10 engine has a proven track record of durability and low-hassle maintenance. Extremely smooth running with a commanding 362-horsepower and 457 lb.-ft. of torque.

**B | POWER 4-WHEEL DISC ANTI-LOCK BRAKES**

Maintains brake balance in heavy use and varying road conditions. Reduces wheel lock up and helps maintain superior steering control.

**C | BILSTEIN SHOCKS**

Long lasting, rugged shocks provide greater stability and better road handling.

**D | TORQSHIFT™ 5-SPEED AUTOMATIC TRANSMISSION**

Provides crisp, firm and quick shifting without sacrificing driver comfort.

**E | LIMITED WARRANTY**

The Ford® Motorhome Chassis has a Bumper-to-Bumper Limited Warranty for 3 years or 36,000 miles and a Powertrain Limited Warranty for 5 years or 60,000 miles, whichever comes first.

Taking the extra time to ensure the best possible structure is exactly what you deserve, and this is why Thor Motor Coach insists on vacuum-bond laminating not only the sidewalls of the motorhome, but also the floor and roof. Vacuum-bonding is the optimum manufacturing process to ensure multi-layer integrity.



**ROOF**

- A** One-piece exterior TPO membrane
- B** Luan panels
- C** Aluminum structure with bowed framing
- D** Block foam insulation
- E** Interior decor panel with reflective vinyl covering

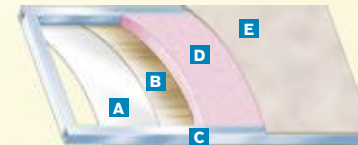

**SIDEWALLS**

- A** High-gloss or gel-coat fiberglass
- B** Luan panels
- C** Aluminum structure with framing at all openings
- D** Block foam insulation
- E** Interior panel with designer wall covering



**FLOOR**

- A** Residential vinyl flooring or carpet
- B** OSB structure wood base
- C** Structural steel framing
- D** Block foam insulation
- E** Luan with woven plastic exterior finish

# FLOOR PLANS

## 27.1

Chassis	Ford
Gross Vehicle (GVWR)	16,000
Gross Combined (GCWR)	23,000
Wheel Base	178"
Exterior Length (w/o ladder)	28'-7"
Exterior Height (w/AC)	12'-2"
Exterior Width (w/o mirrors)	99"
Interior Height	84"
Awning Size	14'
Fuel (gal)	80
LPG (lbs)	88
Fresh/Waste/Gray Water (gal)	50 / 29 / 44
Water Heater (gal)	6
Furnace (BTUs)	30,000
Exterior Storage Capacity (cu. ft.)	80

## 27.1

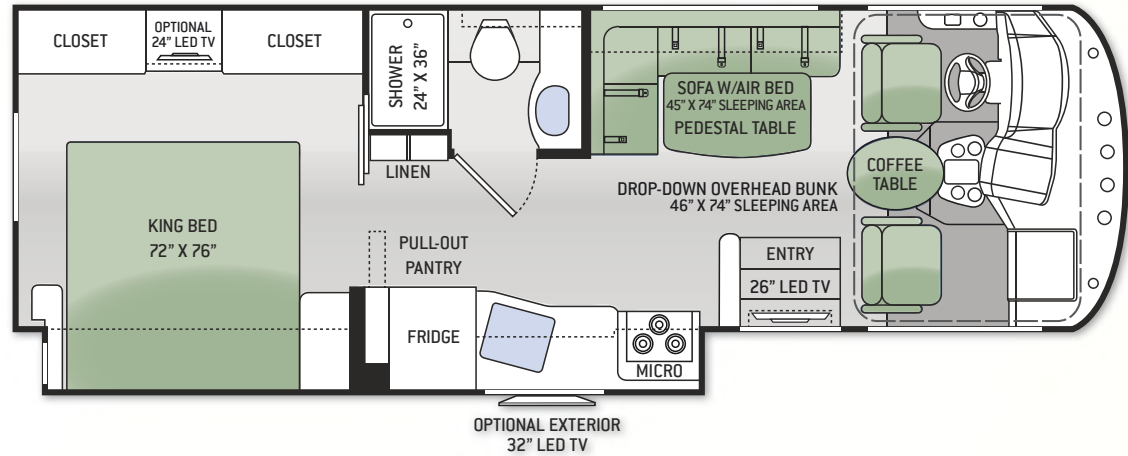

## 29.2

Chassis	Ford
Gross Vehicle (GVWR)	16,000
Gross Combined (GCWR)	23,000
Wheel Base	190"
Exterior Length (w/o ladder)	29'-7"
Exterior Height (w/AC)	12'-2"
Exterior Width (w/o mirrors)	99"
Interior Height	84"
Awning Size	14'
Fuel (gal)	80
LPG (lbs)	88
Fresh/Waste/Gray Water (gal)	50 / 24.5 / 44
Water Heater (gal)	6
Furnace (BTUs)	35,000
Exterior Storage Capacity (cu. ft.)	122.6

## 29.2

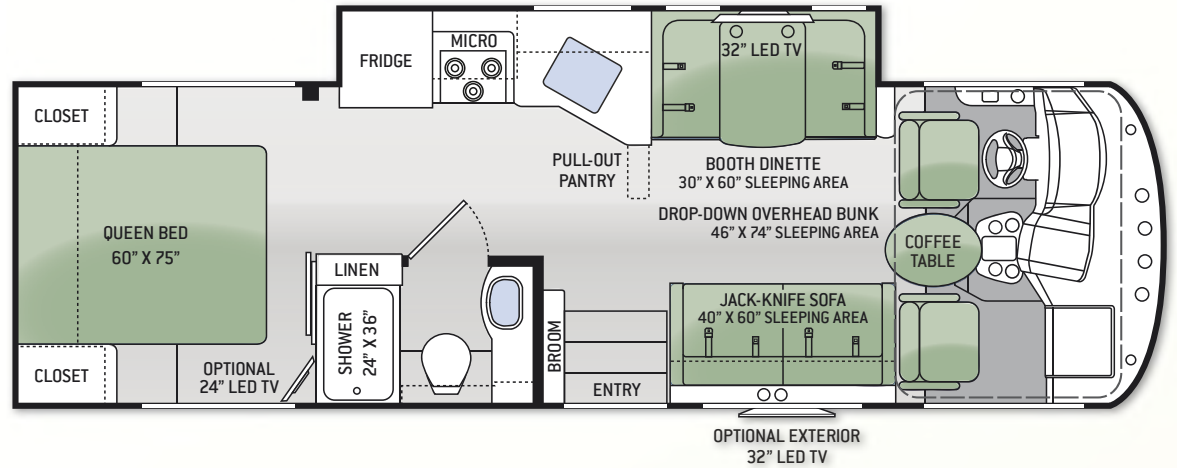

## 29.3

Chassis	Ford
Gross Vehicle (GVWR)	18,000
Gross Combined (GCWR)	23,000
Wheel Base	190"
Exterior Length (w/o ladder)	29'-7"
Exterior Height (w/AC)	12'-2"
Exterior Width (w/o mirrors)	99"
Interior Height	84"
Awning Size	18'
Fuel (gal)	80
LPG (lbs)	88
Fresh/Waste/Gray Water (gal)	50 / 26 / 47
Water Heater (gal)	6
Furnace (BTUs)	35,000
Exterior Storage Capacity (cu. ft.)	84

## 29.3

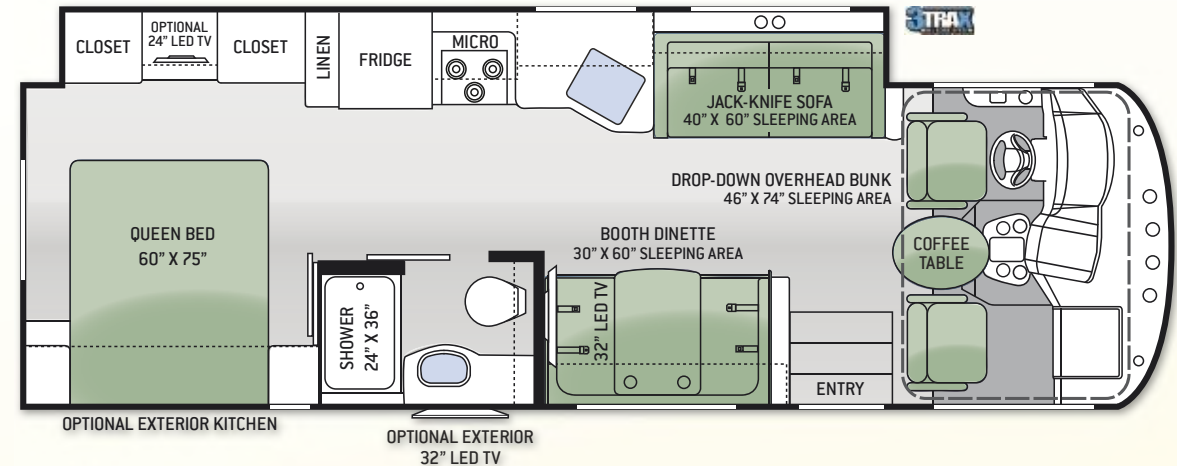

30.1

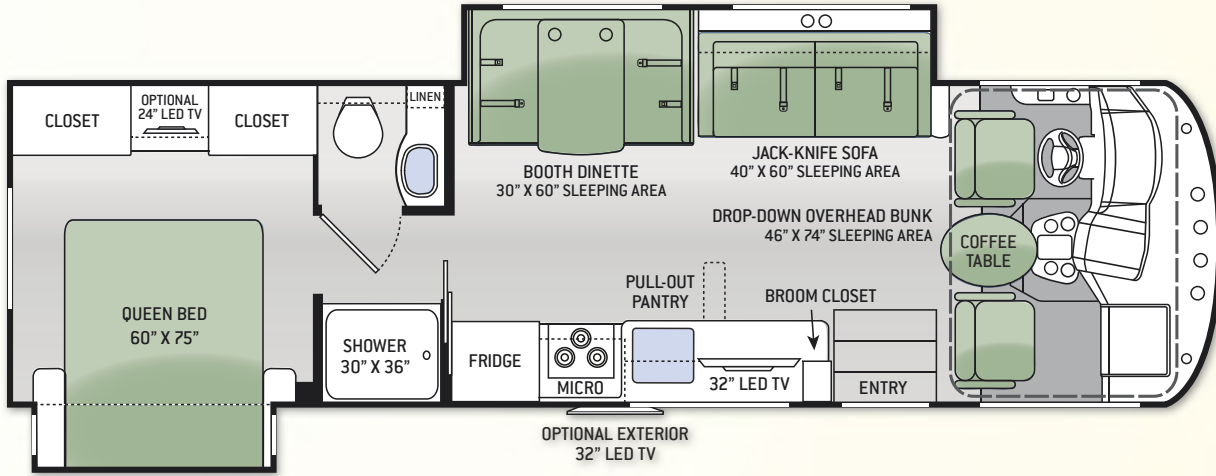

30.1

Chassis	Ford
Gross Vehicle (GVWR)	18,000
Gross Combined (GCWR)	23,000
Wheel Base	190"
Exterior Length (w/o ladder)	30'-10"
Exterior Height (w/AC)	12'-2"
Exterior Width (w/o mirrors)	99"
Interior Height	84"
Awning Size	14'
Fuel (gal)	80
LPG (lbs)	88
Fresh/Waste/Gray Water (gal)	50 / 24.5 / 44
Water Heater (gal)	6
Furnace (BTUs)	35,000
Exterior Storage Capacity (cu. ft.)	68

30.2

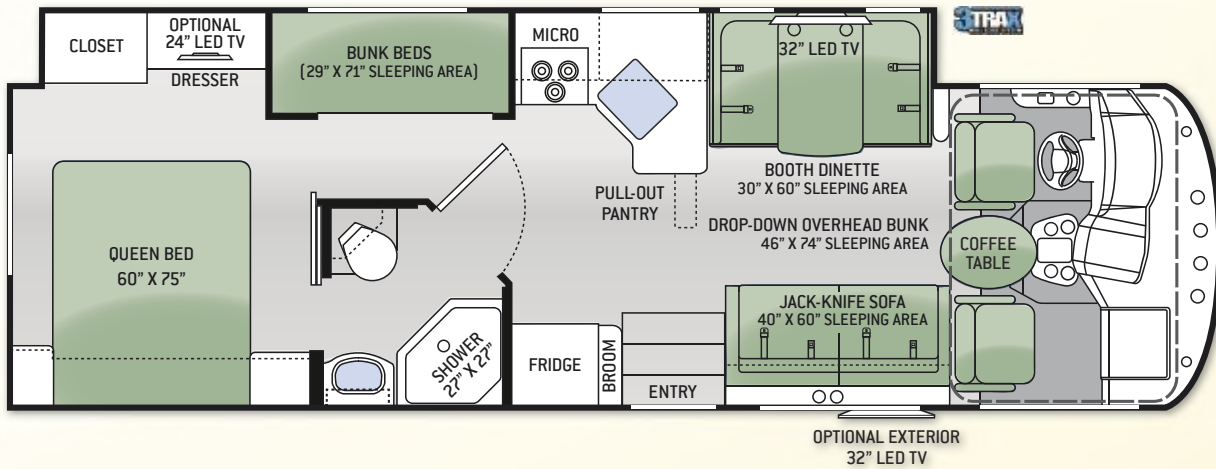



30.2

Chassis	Ford
Gross Vehicle (GVWR)	18,000
Gross Combined (GCWR)	23,000
Wheel Base	190"
Exterior Length (w/o ladder)	31'-4"
Exterior Height (w/AC)	12'-2"
Exterior Width (w/o mirrors)	99"
Interior Height	84"
Awning Size	19'
Fuel (gal)	80
LPG (lbs)	88
Fresh/Waste/Gray Water (gal)	50 / 28 / 40
Water Heater (gal)	6
Furnace (BTUs)	35,000
Exterior Storage Capacity (cu. ft.)	95



# STANDARDS & OPTIONS

## CONSTRUCTION & EXTERIOR

- Ford® F-53 SuperDuty Chassis - 6.8L Triton® V10 Engine, 362HP, 457 lb.-ft. Torque - TorqShift® 5-Speed Automatic with Overdrive Transmission
- One-Piece Fiberglass Front Cap
- Fully Welded Tubular Steel Welded Floor System
- Fully Welded Tubular Aluminum Roof & Sidewall Cage Construction
- Vacu-Bond Laminated Roof, Walls & Floor with High-Density Block Foam Insulation
- Premium One-Piece TPO Roof 
- HD-MAX™ Exterior with Graphics Package
- Automatic Hydraulic Leveling Jacks with Touchpad Controls
- MEGA Storage™ Compartment
- Rotocast Storage Compartments
- Pet-Link™ Multi-Purpose Tie-Down
- Power Patio Awning with Integrated LED Lighting
- 3TRAX™ Wall Slide System (29.3 & 30.2) 
- Frameless Windows
- Rubber Tread Entry Steps with Utility Storage & Mudroom™ Compartment
- Automatic Single Electric Entry Step
- Outside Shower
- Roof Ladder

## CONSTRUCTION & EXTERIOR OPTION

- Full-Body Paint Package with Gel-Coat Sidewalls

## AUTOMOTIVE & COCKPIT

- Touchscreen Dash Radio with CD Player & Back-Up Monitor
- Heated/Remote Exterior Mirrors with Integrated Side View Cameras

- Reclining/Swivel Leatherette Captain's Chairs with Stow-Away Coffee Table in between
- Windshield Privacy Shade
- Conversation Mirrors
- Bird's Eye™ Window
- Valve Stem Extenders on Rear Tires
- 19.5" Tires with Stainless Steel Wheels
- 8,000-lb. Trailer Hitch\*
- Dash Workstation with 110-volt & 12-volt Outlets

## INTERIOR

- Residential Vinyl Flooring (except in Cockpit)
- 84" Interior Ceiling Height
- Hard Vinyl Ceiling
- LED Ceiling Lighting
- Ceiling Ducted Air Conditioning System
- Flat Panel Cabinetry with Nickel Finish Hardware
- Better Homes and Gardens® RV Fabric Collection
- Leatherette L-Shaped Sofa with Air Bed & Pedestal Table (27.1)
- Leatherette Jack-Knife Sofa (29.2, 29.3, 30.1 & 30.2)
- Leatherette Booth Dinette (29.2, 29.3, 30.1 & 30.2)
- Power Drop Down Hide-Away Overhead Bunk
- Window Privacy Shades

## INTERIOR OPTION

- Powered Fan in Living Area

## KITCHEN

- Double Door Refrigerator
- 3-Burner Gas Cooktop with Oven
- Microwave Oven
- Laminate Countertops

- Oversized Bowl Sink with Single Handle Kitchen Gooseneck Faucet
- Pull-Out Pantry
- Coat/Broom Closet with Hanging Hooks (29.2, 30.1 & 30.2)
- Waste & Recycling Containers
- Ball-Bearing Metal Drawer Guides

## BEDROOM & BATHROOM

- Denver Mattress® King Size Bed (27.1)
- Denver Mattress® Queen Size Bed (29.2, 29.3, 30.1 & 30.2)
- Designer Headboard, Bedspread & Pillow Shams
- Bunk Beds (30.2)
- Linen Closets in the Hallway & Bathroom (27.1, 29.2 & 29.3)
- Linen Closet in Bathroom (30.1)
- Pull-Out Kibble Station™ with FDA Approved Pet Bowl Liner
- Foot Flush Porcelain Toilet
- Curved Shower Rod with Micro Anti-Bacterial Shower Curtain (27.1, 29.2, 29.3 & 30.1)
- Shower with Glass Door (30.2)

## BEDROOM & BATHROOM OPTION

- Powered Fan in Bedroom

## ENTERTAINMENT

- 26" LED TV in Living Area (27.1)
- 32" LED TV in Living Area (29.2, 29.3, 30.1 & 30.2)
- Two (2) 13" LED TVs & DVD Player in Bunk Bed Area (30.2)\*
- Bluetooth® Coach Radio System in Bedroom with Exterior Speakers
- Power Charging Center for Electronics
- Cable TV Ready

## ENTERTAINMENT OPTIONS

- 24" LED TV in Bedroom
- Exterior 32" LED TV
- Exterior Kitchen with 1000-watt Inverter, 2.5 cu. ft. Refrigerator, Sink & Portable Gas Grill (29.3)

## ELECTRICAL & PLUMBING

- Cummins Onan® RV QG 4000 Gas Generator
- 30-amp Service with Detachable Shoreline Power Cord
- 13,500 BTU Roof Air Conditioner
- Emergency Start Switch
- Battery Disconnect Switch
- Below-Floor Mounted 6-gallon DSI Gas/Electric Water Heater (27.1, 29.2 & 30.1)
- Above-Floor Mounted 6-gallon DSI Gas/Electric Water Heater (29.3 & 30.2)
- Below-Floor Mounted 30,000 BTU LP Furnace (27.1)
- Below-Floor Mounted 35,000 BTU LP Furnace (29.2 & 30.1)
- Above-Floor Mounted 35,000 BTU LP Furnace (29.3 & 30.2)
- Water Heater Bypass System
- Heated & Enclosed Holding Tanks (27.1, 29.2 & 30.1)
- Holding Tanks with Heat Pads (29.3 & 30.2)
- Systems Control Center

## ELECTRICAL & PLUMBING OPTIONS

- 15,000 BTU Roof Air Conditioner
- Second Auxiliary House Battery

\*INCLUDED ON UNITS BUILT AFTER 10/11/14

Thor Motor Coach is the industry leader in innovative design and builds a variety of unique styles, sizes and floor plans that feel custom-made – at a truly competitive price.

IMPORTANT - PLEASE READ: This brochure reflects product design, fabrication, material, components and specifications at the date of printing, which date is disclosed on the last page. PLEASE VISIT US ONLINE AT THORMOTORCOACH.COM OR CONSULT WITH YOUR SELLING DEALERSHIP FOR THE LATEST IN STANDARDS, OPTIONS, SPECIFICATION AND TECHNICAL INFORMATION. Photographs in the brochure may depict optional equipment or may only be available in certain floor plans. Components, appliances and the chassis may have been manufactured in a calendar year before the vehicle's designated model year. All capacities are approximate. The actual length of the vehicle may differ from that indicated in the brochure due to variances in the manufacturing processes and/or installed components. All dry weights are based on standard model features and do not include optional features or equipment. Component part and appliance manufacturers issue limited warranties covering portions of the vehicle not covered under the limited warranty we issue.

Copyright Thor Motor Coach, Inc. © 12/15/14

**LA MESA RV**  
EXPERIENCE LIFE  
[www.lamesarv.com](http://www.lamesarv.com)  
800-496-8778

YOUR LOCAL THOR MOTOR COACH DEALER



Made to fit.

P.O. Box 1486, Elkhart, IN 46515  
Sales Department: 800.860.5658  
Customer Service: 877.855.2867

[ACEMotorhome.com](http://ACEMotorhome.com)

